

Product description	M12-B male panel mount connector, Contacts: 4, not shielded, dip-solder, IP68, UL, M12x1.0, front mounting
Area	M12-B series 766
Order number	86 1033 1100 00004

Illustration

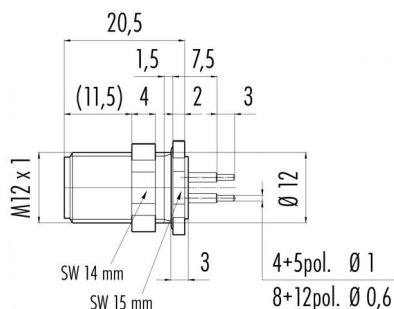

Scale drawing



Contact arrangement (Plug-in side)

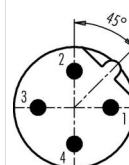

	X	Y
1	2,50	0,00
2	0,00	2,50
3	-2,50	0,00
4	0,00	-2,50

- 1 brown
- 2 white
- 3 blue
- 4 black

You can find the assembly instructions on the next page.

Technical data

General values

Notice

Please note that, due to the change from the old to the new order number, there may be deviations in the technical specifications. For questions about product details, please use the 'Contact Customer Service' form on the right.

Connector design
Connector locking system
Termination
Upper limit temperature
Lower limit temperature
Customs tariff number
Packaging Unit

male panel mount connector
screw
dip-solder
85 °C
- 40 °C
85369010
20

Cable data

Approval 1

UL

Electrical values

Rated current (40 °C) 4 A
Rated voltage 250 V
Rated impulse voltage 2500 V
Pollution degree 3
Overvoltage category II
Insulating material group II
Insulation resistance > 10⁸ Ω
EMC compliance not shielded
Degree of protection IP68
Mechanical operation > 100 Mating cycles

Material

Contact material CuZn (brass)
Contact plating Au (gold)
Contact body material PA
Housing material Zinc die-cast nickel-plated
REACH SVHC CAS 80-05-7
(4,4'-isopropylidenediphenol)
CAS 7439-92-1 (Lead)
CAS 61788-32-7 (Terphenyl, hydrogenated)

Product description **M12-B male panel mount connector, Contacts: 4, not shielded, dip-solder, IP68, UL, M12x1.0, front mounting**

Area **M12-B series 766**

Order number **86 1033 1100 00004**

Assembly instructions / Panel cut-out

Als Flanke als Schutzflanke



Als Deckungsflanke

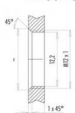

Einbaueinheit: 60 mm x 12.5 mm

Anschlußmessung

Handgeprüfte/Prüfstrommesser 6,35 kV
Handgeprüfte/Schnellstrommesser 1,00 kV
Handgeprüfte/Prüfstrommesser 1,25 kV

Leitungsart	Leitung	max. (mm)
Leitung	2	3,5
Leitung	2	3,5
Leitung	2	3,5
Leitung	2	3,5
Leitung	2	3,5
Leitung	2	3,5
Leitung	2	3,5
Leitung	2	3,5

Einbaueinheit

1) Keine feste Abdeckung
2) Handgeprüfte bis 1,5 mm Durchmesser (SI 5285) verwenden
3) Handgeprüfte bis 1,5 mm Durchmesser (SI 5285) verwenden
4) Handgeprüfte bis 1,5 mm Durchmesser (SI 5285) verwenden

Product description	M12-B male panel mount connector, Contacts: 4, not shielded, dip-solder, IP68, UL, M12x1.0, front mounting
Area	M12-B series 766
Order number	86 1033 1100 00004

Security notices

The connector must not be connected or separated under load. Non-observance and incorrect use can result in personal injury.

The connectors are designed for use in plant, control system and electrical equipment. The end user is responsible for checking whether the connectors are suitable for use in other applications.

Connectors with degree of protection IP 67 and IP 68 are not suitable for use under water. When used outdoors, the connectors must be separately protected against corrosion. For further information about IP degrees of protection refer to 'Technical support' in the Download Centre.